

Emergency Exit Device for use with Access Control Systems

The Em Rex® (Emergency Exit Device) is an emergency door release unit which can be used on its own or in conjunction with the Prox Rex® units, to make up a total access controlled exit solution.

Installation:

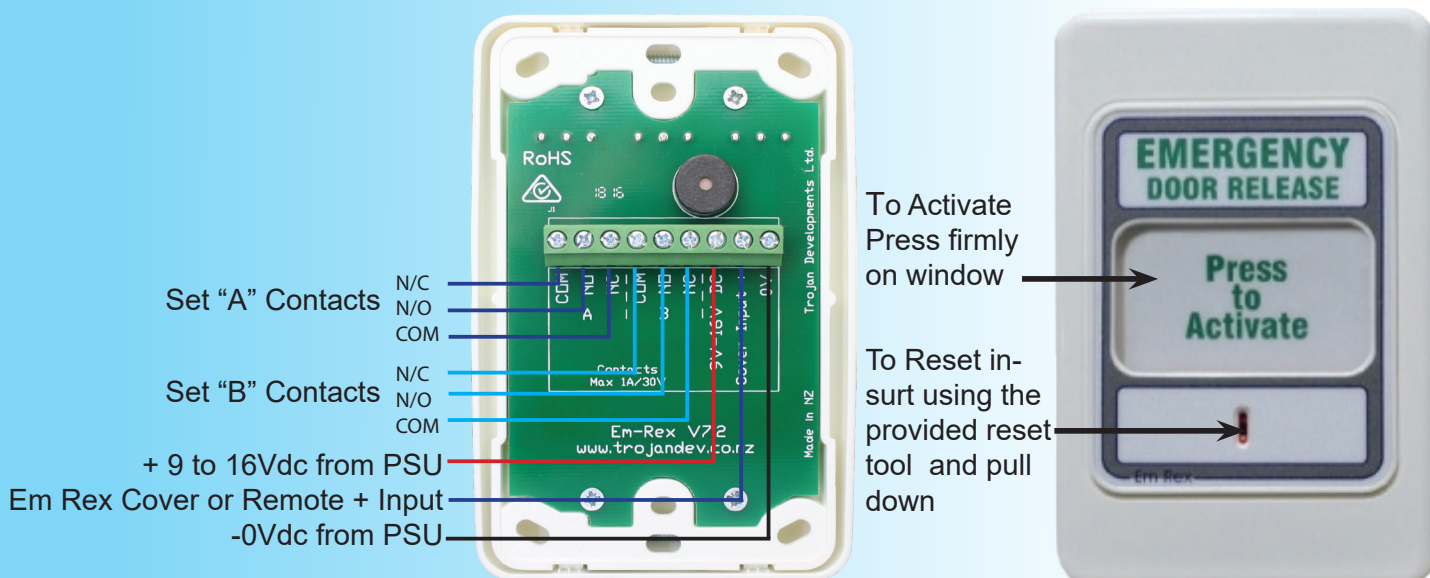

Specifications:

- ▼ Single gang profile fits standard electrical flush box
- ▼ Power requirements 9 to 16Vdc (only if using on board sounder or optional cover)
- ▼ 10mA at 13.6 Vdc
- ▼ Two sets of Clean Common N/O and N/C outputs
- ▼ The contacts are rated at 1 AMP 30Vdc
- ▼ The face plate will not deteriorate over time and is easily cleaned
- ▼ CE Certified & complies with BS 5839 Pt 2. Standard for "Break-Glass Panels"

Product code:

- ▼ Em Rex

▼ www.trojandev.co.nz

▼ sales@trojandev.co.nz

